

Directions to Mililani Recreation Center #5
 95-1101 Ainamakua Drive
 Mililani, HI 96789

Mililani Mauka

From Honolulu:

- Exit H-2 on Mililani Mauka cutoff
- Merge onto Meheula Parkway

From Wahiawa:

- Exit H-2 on Mililani cutoff
- Turn left onto Meheula Parkway

Then:

- Turn right onto Ainamakua Drive
- Turn into 1st driveway on right
- Rec. Center #5 is just past the Castle & Cooke Sales Office (white building), proceed to gray building at end.

****NOTICE****

MTA will not assume any responsibility for parking in grass areas.

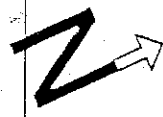

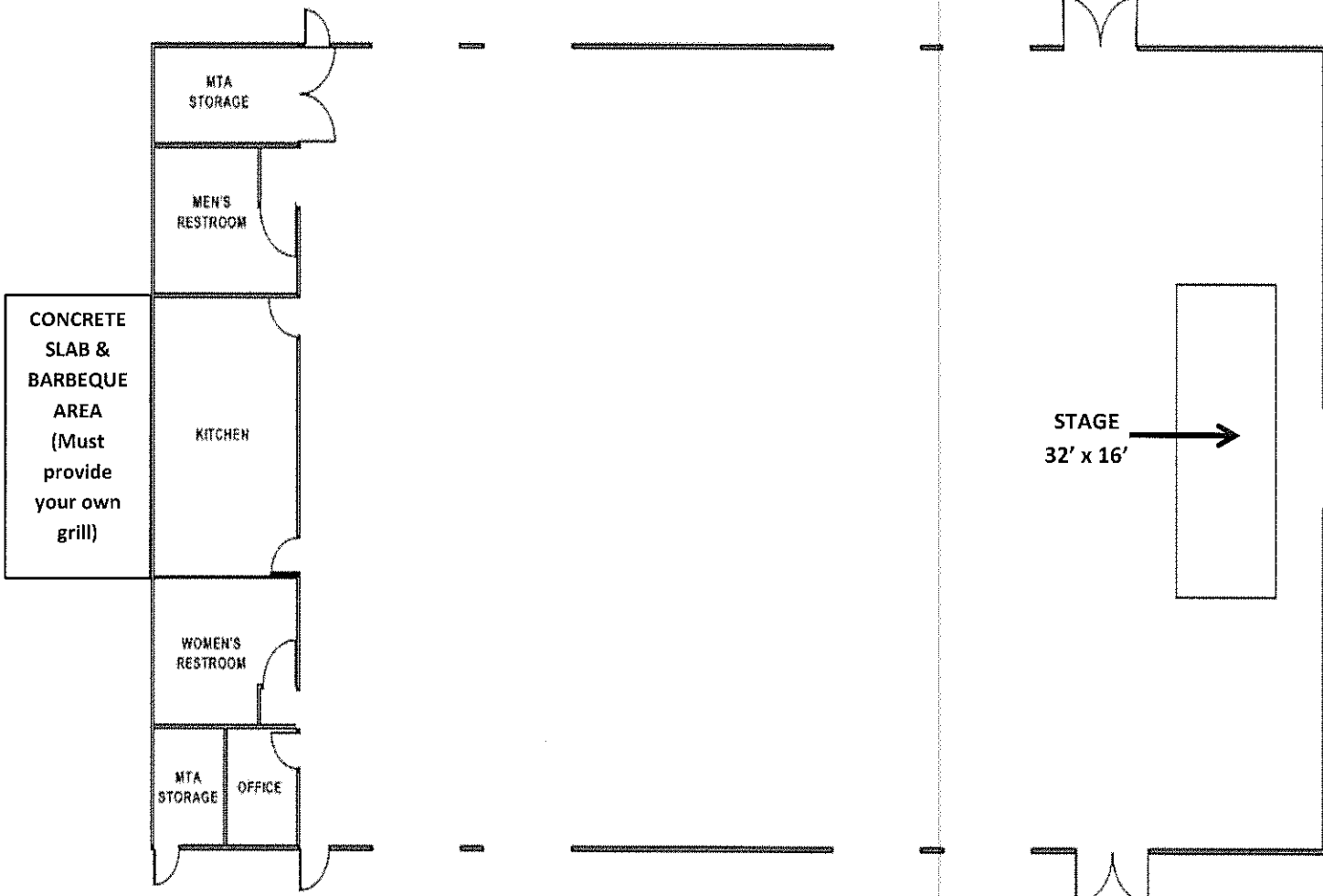

Recreation Center 5
 95-1101 Ainamakua Drive
 Phone: (808)440-2605
 Maximum capacity= 350 people
 72 rectangular tables provided
 (Tables: 30" x 6')
 355 chairs provided
 Room size: 114' x 64'

Bouncers
 Bouncers are allowed inside of the hall or in the parking lot. Stakes are prohibited. Generators must be kept outside.

The Renter on the contract must submit an indemnification agreement form to MTA and the owner of the bouncer/vendor must submit a certificate of insurance which covers Mililani Town Association as an "additional insured" for at least \$1,000,000.00 coverage. All paperwork is due at least 30 days prior to the event date.

- Hall Rental Times**
- **Friday Night:**
 - Set-up: 3:00pm- 5:00pm
 - Party: 5:00pm- 10:00pm
 - Vacate Time: 10:30pm
 - **Saturday Night:**
 - Set-up: 3:00pm- 5:00pm
 - Party: 5:00pm- 10:00pm
 - Vacate Time: 10:30pm
 - **Sunday Day:**
 - Set-up: 8:00am- 10:00am
 - Party: 10:00am- 2:00pm
 - Vacate Time: 2:30pm
 - **Sunday Night:**
 - Set-up: 3:00pm- 5:00pm
 - Party: 5:00pm- 10:00pm
 - Vacate Time: 10:30pm